

KANSAS SOCIETY OF LAND SURVEYORS

PRESENTS THE

59TH ANNUAL MEETING AND
CONFERENCE

EXHIBITOR REGISTRATION

*United Wireless
Conference Center*

*4100 W Comanche
Dodge City, KS*

*OCTOBER 20-22,
2016*



KANSAS SOCIETY OF LAND SURVEYORS

2016 ANNUAL CONFERENCE

OCTOBER 20-22, 2016



AGENDA

THURSDAY, OCTOBER 20, 2016

1:00-3:00pm	Room 1 Ownership of Navigable River Lands between Meander Lines (open to public) Charles Doman-BLM and Burk Griggs-Visiting Assoc Professor, Washburn University School of Law; Formerly Assistant Attorney General Specializing in water law, State of KS	Room 2 Road Right-of-Way Chip Woods
3:00-3:15 pm	Break	
3:15-5:15pm	Ownership of Navigable River Lands between Meander Lines	KS Minimum Standards Jason Johnson
5:30pm	Vendor Social in the Conference Center	
5:45pm	KSLS Board of Directors Dinner	
6:15pm	KSLS Charitable Foundation BOD Meeting	
6:45pm	KSLS Board of Directors Meeting	

FRIDAY, OCTOBER 21, 2016

8:00am-9:45am	Room 1 Permanent Survey & Clerks/Mayor Plat Vernon Cress, Kevin Noll, Duane Palmberg	Room 2 OPUS Share/NGS Data Explore Brian Ward, NOAA
9:45am-10:00am	Break	
10:00am-12:00pm	Permanent Survey & Clerks/Mayor Plat Cress, Noll & Palmberg	Break Reference Reports Lynn Engle/ Ken Parks
12:00pm-1:30pm	Lunch and KSLS Business Meeting	
1:30pm-3:15pm	Client Communications- Bill Beardslee	GLO Survey of Standard Parallels, Guide Meridians & Township Lines Tom Maestas-BLM
3:15pm-3:30pm	Break	
3:30pm-5:30pm	Client Communications cont... Bill Beardslee	Break Ethics Larry Graham/Steve Brosemer

SATURDAY, OCTOBER 22, 2016

8:00am-9:45am	Room 1 Subdivision Design Concepts Bill Beardslee	Room 2 KDOT Record/Research Bill Haverkamp/Thad Fowler
9:45am-10:00am	Break	
10:00am-12:15pm	Subdivision Design cont. Bill Beardslee	Break KS Minimum Standards Jason Johnson

KANSAS SOCIETY OF LAND SURVEYORS

ANNUAL CONFERENCE

Exhibitor Set Up

Exhibitor booth space will include: 1-6' table, 2 chairs, a full page ad in the handout booklet, 1 meal ticket for Friday's lunch and snacks.

Exhibitor Hours

Exhibitors will set up on Thursday, October 20, 2016 anytime after 10am. All classes will be held in the adjoining room and participants will be encouraged to visit the Exhibitors during all available times. Exhibitors will break down their booth after the afternoon break around 3pm on Friday, October 22, 2016.

Social Hour

Exhibitors are encouraged to join us for Social Hour on Thursday Evening Oct 20, 2016 starting at 5:30pm. Sponsorships are always welcome. If you would like to donate to this function, please indicate on the registration form.

Lunch

One lunch meal tickets and snacks will be provided with each booth space. **Additional lunch tickets may be purchased in advance.**

Ad Space

Each Exhibitor will be given a full page ad space in the handout booklets. The ads will need to be turned into Valeri by August 15th to get into the booklet.

Scholarship Fund

At this current time there is no activity scheduled for the Scholarship Fund. Any contribution to the KSLs Charitable Foundation would be a tax deductible. EIN # 61-1563408

Location & Lodging Accommodations

The United Wireless Conference Center is the site for the 2016 KSLs Annual Conference, located at 4100 W Comanche, Dodge City, KS 67801.

Hampton Inn & Suites at 4002 W Comanche St Dodge City, KS 67801 (620)225-0000 for \$99 for King Bed Rooms per night.

or

La Quinta Inn & Suites 2400 W Wyatt Earp Blvd, Dodge City, KS 67801 (620) 225-7373 for \$85 for Queen Bed Rooms per night.

Special pricing mention "**KS Land Surveyor**" for block price.

Cancellation Policy

We reserve the right to cancel the program and return all fees in the event of insufficient registration. A participant may cancel a registration up to two weeks before the course date and receive a full refund. **Any cancellation after Oct 7th, will receive a full refund minus \$50.**

Any registrations received after **Oct 7, 2016 will have a \$45 Late Fee assessed.**

Payment

The total fee is required with the application to reserve your space. Make checks payable to Kansas Society of Land Surveyors (KSLs)

For More Information

Valeri Peltier, KSLs Executive Director,
316-680-5159 or exec@ksls.com

Send in all Exhibitor Registration material to:
KSLs

PO Box 757
Andover, KS 67002
Fax 316-425-7773

Or Register on line with a credit card at KSLs.com

GENERAL INFORMATION

REGISTRATION

Company Name: _____
 Contact : _____
 Address: _____
 City/State/Zip: _____
 Phone: _____ Email Address: _____
 Special Needs: _____

This application/contract is made in accordance with the Exhibitor Regulations and Information

Additional Nametags

1. _____
2. _____
3. _____

Please indicate first through third booth choice:
 (see diagram on opposite page)

1st _____

2nd _____

3rd _____

Liability

It is expressly understood and agreed that the Exhibitors assume the entire responsibility and liability for losses, damages, and claims arising out of the loss, injury or damages to Exhibitors' display, equipment and other property brought onto the premises of the Conference Center. The Conference Center doors will be locked each night after we leave for the evening.

Exhibitor Costs

Booth Rental:		
KSLs Sustaining Member:	\$ FREE	\$ _____
NON Sustaining Member:	\$300.00	\$ _____
Additional Lunch Tickets:	\$ 15.00	\$ _____
KSLs Scholarship Foundation Donation:		\$ _____
Donation to Exhibitors Social Hours Thursday Night		\$ _____
Late Fee after Oct 7th	\$45.00	\$ _____
TOTAL DUE		\$ _____

Payment Information

Registration Deadline is Oct 7, 2016

Registration Options:

1. Go to KSLs.com and register on-line with Credit Card
2. Mail this form with a check to KSLs, PO Box 757, Andover, KS 67002



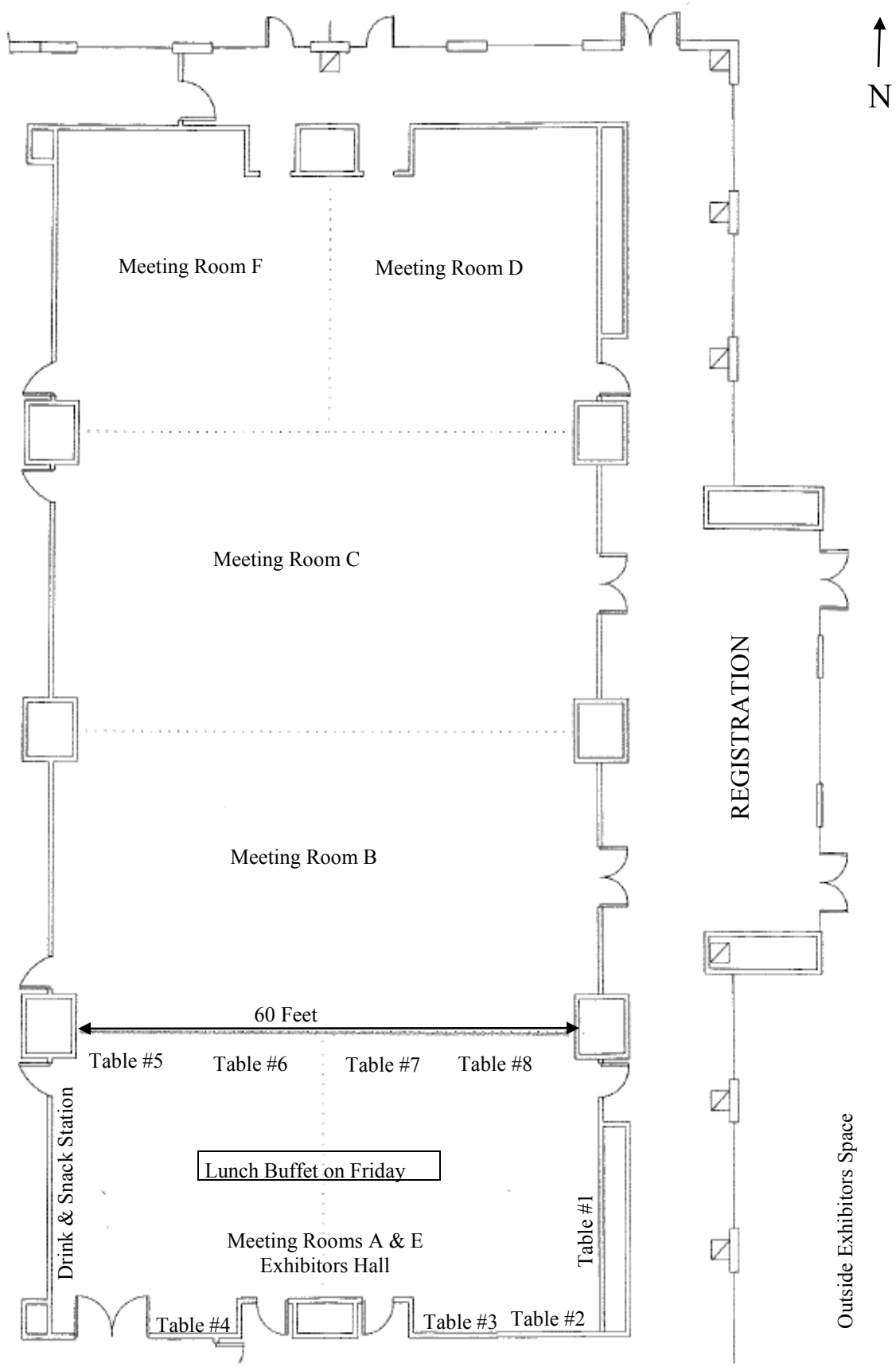

MAP OF CONFERENCE CENTER